

98
B.P. -20

H/126

[N.L.C.—9.]

*Road one chain wide
ordered over 33/9 E 1918*

APPLICATION FOR ROAD [OR PRIVATE WAY].

(RULE 38.)

The Native Land Act, 1909, and the Native Land Amendment Act, 1913.

TO THE NATIVE LAND COURT.

Rotorua

I, *The Commissioner of Crown Land*, being *Auckland*,
the owner of the land known as⁽¹⁾

(1) Description by block and section number of land to which access is sought.

do hereby apply to have a road [or private way] laid off over the land known as

(2) Description by block and section number of land over which a road is sought.

Sec 337^c Waioeka P.S. adjoining thereto in order to give access or ~~better~~ access to the first-mentioned land. *main road*

~~OPOTIKI 180-17~~

OPOTIKI *16-9-18-57

HHS

As witness my hand, this *8th* day of *August*, 1917.

H. J. Keck
Commissioner of Crown Land

NOTE.—This application must be accompanied by a plan showing generally the location of the proposed road.

AUCKLAND LAND DISTRICT

OPOTIKI

COUNTY

BLK XI OPOTIKI SURVEY DISTRICT

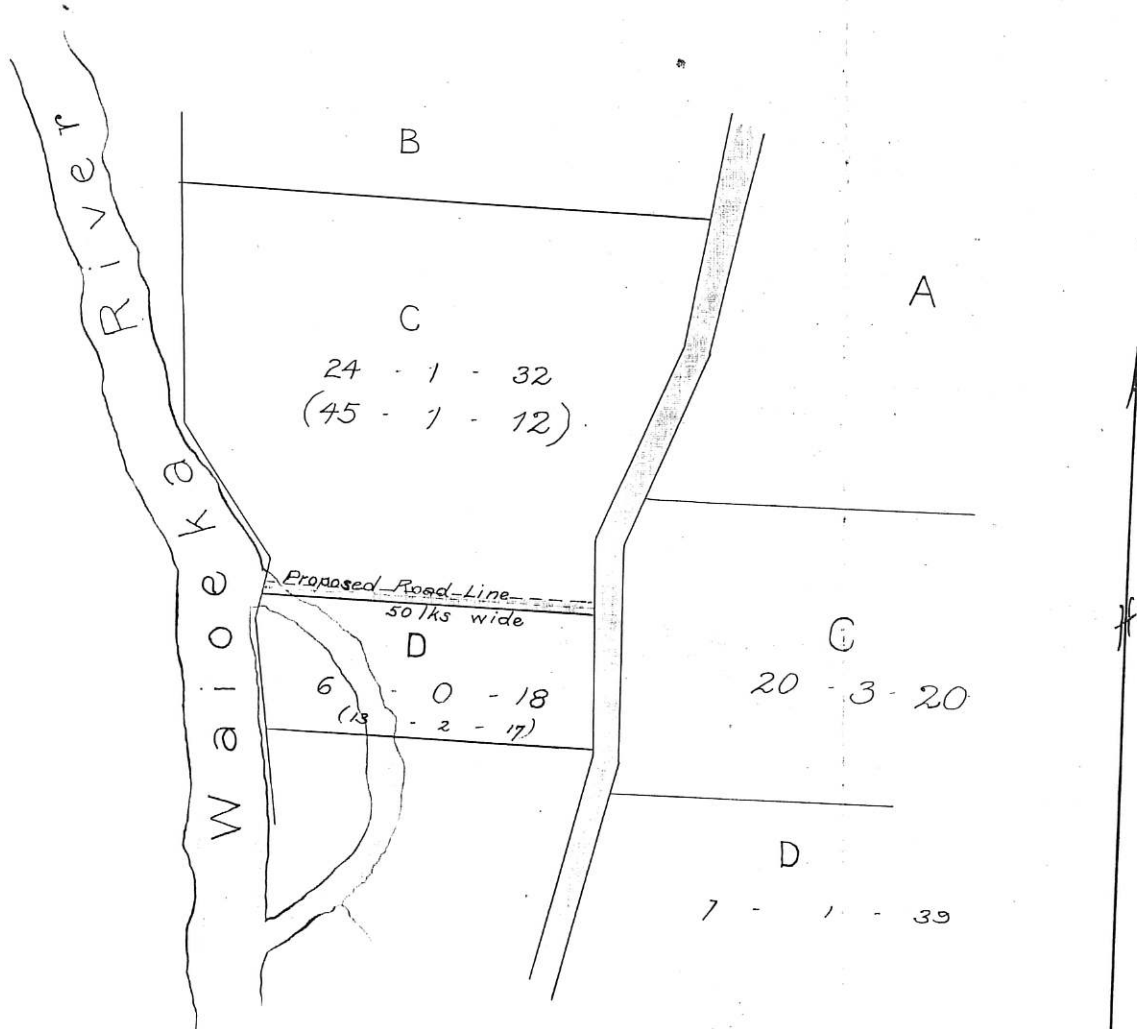

Plan Subdn. of Sec 337 Waioeka Psh. Shewing proposed road line.

Surveyed by Chas. Diehl. Oct 1911.

Scale 5 chains to an inch.

plan 8119